

OLE SERENE HOTEL

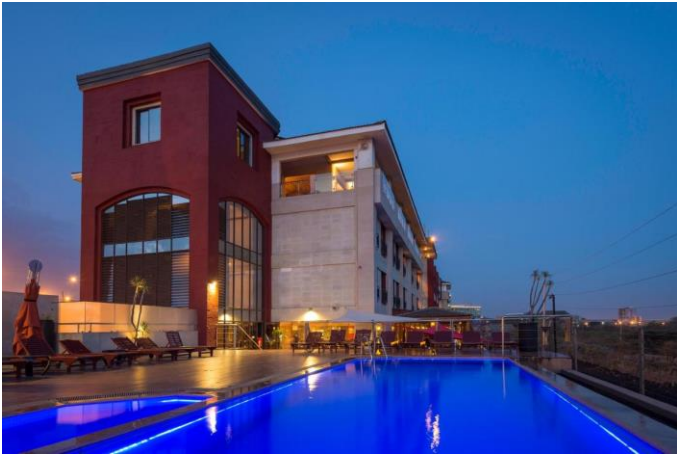

Overlooking the Nairobi National Park, Ole-Sereni features an outdoor pool, 2 restaurants and a snack bar. The hotel's health club offers aerobics, steam, sauna, massage facilities and a salon.

Ole-Sereni Hotel is decorated with the typical style of a safari lodge, including bright colours, wooden details and artwork in raw materials. The contemporary rooms come with wall-mounted flat-screen TVs, free WiFi and a small coffee table. In the bathrooms, black marble combines with large shower boxes, and bathrobes and slippers are available upon request.

The main restaurant has a large deck where you can spot wildlife. It offers grills, Italian, Indian and Oriental cuisine. Evening entertainment and steaks can be enjoyed at Eagle's, which offers views of the National Park and Nairobi's skyline. The Waterhole Snack Bar offers light meals and snacks.

Ole-Sereni is a 10-minute drive from the Jomo Kenyatta International Airport. Free private parking is available.

Sikh Temple Hospital – Makindu



The Gurdwara complex is very large spanning an estimated 5000 square meters and has facilities for langar (free food) around the clock and living accommodation for travelers. Set in the forest off the main road, the Makindu Gurdwara is the only convenient rest stop for weary motorists on this busy and long road to and from Mombasa

Gurdwara was built in 1926 by the Sikhs who were working on the construction of the Uganda railway line from the coast (Mombasa) inland to Lake Victoria and beyond to Uganda. Today, all types of people visit this Gurdwara everyday and it is a 'must-see' Gurdwara for any Sikh travelling to Kenya and East Africa.

Lake Nakuru Sopa Lodge



What are some of the property amenities at Lake Nakuru Sopa Lodge? Some of the more popular amenities offered include free breakfast, a pool, and an on-site restaurant. See all property amenities. What food & drink options are available at Lake Nakuru Sopa Lodge?

Lake Nakuru National Park is mainly a wooded and bushy grassland with a wide ecological diversity and characteristic habitats that range from the lake waters to the escarpment and ridges. Lake Nakuru National Park. 165 Km from Nairobi. 21 Km on all weather road from the Park gate to the Lodge.

Keekorok Lodge



Keekorok Lodge is the first property located in the Masai Mara Game Reserve and it offers traditional accommodations with private patios. Guests can enjoy views of the wildlife from the outdoor pool or the sundeck. All spacious rooms have a balcony, overlooking the garden, pool or Reserve. They are equipped with a ceiling fan, allergy free bedding and mosquito nets. The Lodge serves traditional dishes in the Hippo Bar, overlooking the lake. The Elephant Deck provides a good setting for experiencing a bush dinner. Guest can explore the Keekorok Nature Reserve with a safari and the 24-hour reception can assist. For the younger guests a children's playground is also provided.

Keekorok Airstrip is only a 10-minute drive away and a shuttle service is provided on request.

Guru Nanak Nishkam Sewak Jatha Gurdwara KERICHO



The settlement at Kericho was founded in 1902 by British settlers. Kericho hosts Africa's largest Sikh Gurudwara and the second largest Catholic cathedral in Kenya. Gurdwara Sahib is built on the site of the home and workshop of Kericho Wagon Works founder Sant Baba Puran Singh Ji of Kericho.

Gurdwara Sahib is built on the site of the home and workshop of Kericho Wagon Works founder Sant Baba Puran Singh Ji of Kericho. The site is currently a place of worship for the Sikh community and a museum gazetted by the Government of Kenya as a place of spiritual significance.